

SHEERWATER

REGENERATION PROJECT UPDATE AUGUST 2019

Dear Resident.

At long last, I'm delighted to say we have started the regeneration. On Monday 22 July we started the preliminary works at Bishop David Brown School to build the new leisure centre, swimming pools and sports pitches (the Leisure Phase). This £26 million investment in the infrastructure of Sheerwater is, as promised, the first thing we said we would do to start the regeneration process. Not only will it provide residents with brand new sports facilities, it will also provide the school with fantastic new changing and canteen facilities.

You will also have noticed the wooden hoardings being put up around the first phase of the residential development (the Purple Phase). These will shortly be dressed with #WeAreWoking campaign branding, similar to that which you will have seen around the development in the centre of Woking. This is the Council's commitment to investing in Woking and the regeneration of Sheerwater is one of the biggest, most important projects we're undertaking to improve people's



lives, create local opportunities and supporting communities to thrive.

Inevitably a project of this size will create some issues but I am hoping that by working together we can overcome these.



Over the coming months we will keep you informed of progress.

CLlr David Bittleston
Leader of Woking Borough Council

Scheme update

The Sheerwater Regeneration Housing Support team has been established to help make the regeneration process as smooth as possible for residents.

Tidy place, smiley face

As residents move out of the regeneration area, the team is working hard to ensure everything is kept in a clean and tidy state so that people remaining in the area can live in good conditions. Members of the team

regularly walk around the area on the lookout for fly-tipping or areas that need tidying up but support from the community would be really helpful. If you see anything that needs attention, please contact the team on **01483 743870**.

Evening surgeries

The team is keen to ensure all residents are getting the level of support they need to deal with the difficult and emotional time of moving home.

Now that work has started on site, the team will be holding evening surgeries for residents who work and are unable to attend appointments and drop-in sessions during the day.

The first evening surgery will be being held on **Thursday 12 September** at Parkview Community Centre. Call **01483 743870** to book a one to one, 15-minute session with a housing support officer. Sessions available up until 8pm.



Purple Phase – a closer look

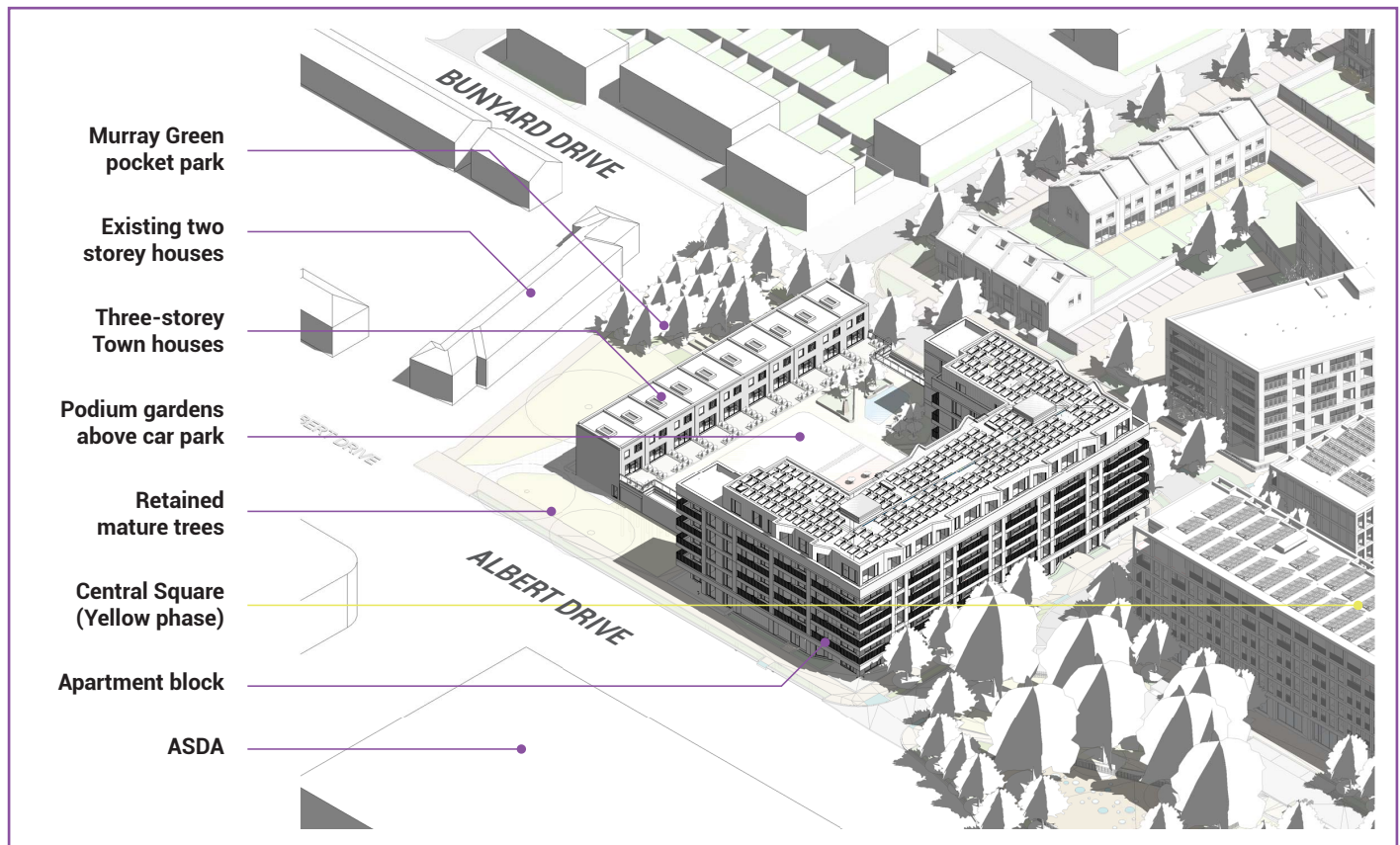

Overview

Purple Phase takes in land currently occupied by 20 two-storey dwellings and Murray Green. Once complete, Purple Phase will consist of 92 properties that will be available for affordable rent, open market sale and rent.

The property mix includes 10 three-storey houses and 82 one, two and three bed apartments.

Facing Murray Green, the three-storey terraced houses will have private gardens. The flat roofs and low parapets minimise the change in height.

The landscape within this phase comprises a pocket park, podium (raised) gardens and tree line frontages to Central Square and Bunyard Drive. The podium gardens conceal a

residents' car park, reducing the impact of roadside parked cars in the area. There are private, enclosed gardens with seating terraces for individual properties and communal open green spaces accessible to all residents.

Happening soon on site

- **Erection of hoardings** – a temporary fence to restrict public access to site
- **Utilities disconnected** – gas, water and electrical supplies to vacant properties safely capped
- **Asbestos removal** – vacant properties searched and stripped of any asbestos safely
- **Demolition** – 20 properties demolished and any reusable materials recovered



Leisure Phase – a closer look



Overview

The new leisure facilities will promote health and wellbeing, and enhance learning and recreational opportunities. Use of these facilities will be shared between the schools, local sports clubs and the local community.

Leisure centre:

- Five court sports hall
- 25m swimming pool and 13m learner pool
- Café / viewing area
- Individual and group changing facilities
- Gym / fitness suite
- Two multi-purpose studios
- Club room and viewing gallery
- Parking for approximately 140 cars

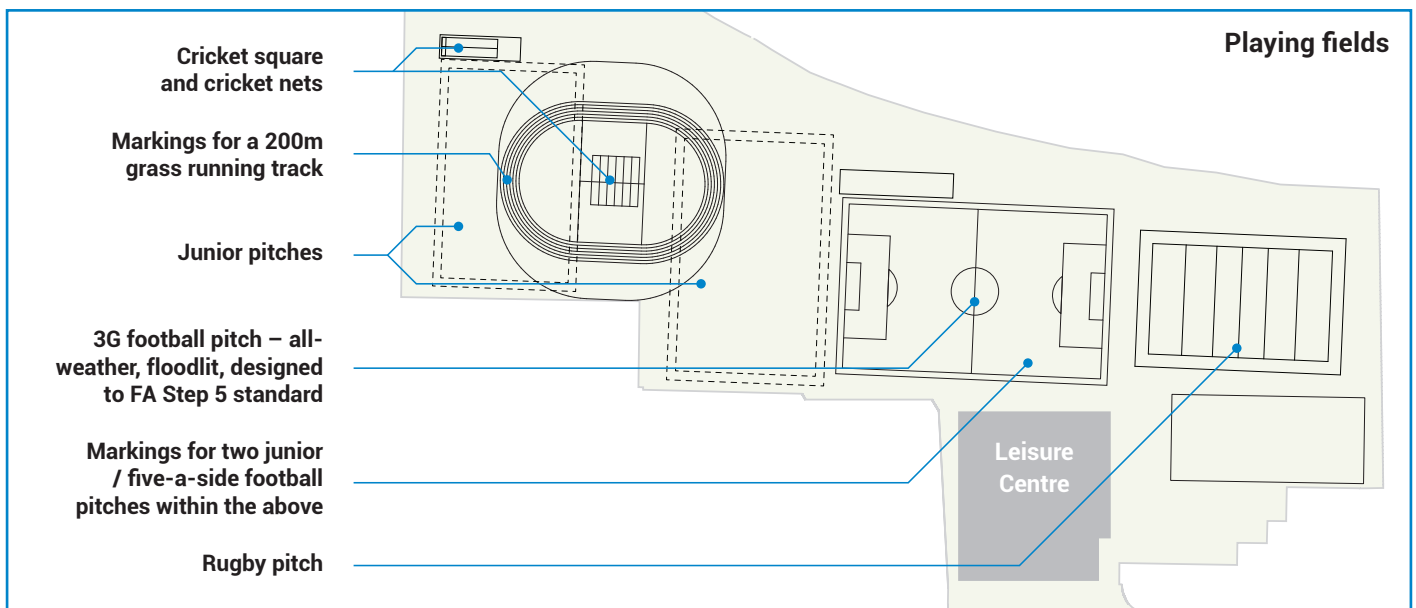

Happening soon on site

- **Construction of a haul road** – so that heavy goods vehicles can bring materials on to site
- **Erection of hoardings** – a temporary fence to restrict public access to site
- **Drainage** – installation of the waste water pipes
- **Preparation of the land** – landscaping and levelling so that the new sports pitches can be laid



Eid Bazaar, so good they did it twice!

Thank you to everyone that attended the Eid Bazaars, on Thursday 30 May and Saturday 3 August. A successful first event saw 20 stallholders selling items of clothing, jewellery, sweets and more to a large number of visitors, prompting calls for a second event to be organised. Members of the community, supported by local businesses and NHS health visitors duly responded.



Need information about the Sheerwater Regeneration Scheme translated?

Email Catharine.Okon@woking.gov.uk or call 01483 743869 for assistance.

Czy potrzebujesz przetłumaczenia informacji o Programie Regeneracji Sheerwater? Wyślij wiadomość pocztą elektroniczną, aby uzyskać pomoc; Catharine.Okon@woking.gov.uk lub zadzwoń pod numer 01483 743869

شیر واٹر کی ترقیاتی سکیم کی معلومات جاننے کے لئے اگر آپ کو ترجمہ کی ضرورت ہے،

تو ای میل: Catharine.Okon@woking.gov.uk

فون نمبر: 01483 743869 پر رابطہ کریں۔

शेरवाटर पुनर्जन्म योजना के अनुवाद के बारे में जानकारी चाहिए? ईमेल

Catharine.Okon@woking.gov.uk या सहायता के लिए 01483 743869 पर कॉल करें "।

के तपाईंलाई शिरवाटर पुनरुत्थान योजना बारे उल्था गरिएको जानकारी आवश्यक छ? सहायताको निम्ति ईमेल गर्नु होला Catharine.Okon@woking.gov.uk वा फोन ०१४८३ ७४३८६९ मा कुरा गर्नु होला।

Sheerwater Together Group

These evening meetings take place monthly at Parkview Centre for the Community giving people the opportunity to raise and discuss issues that impact the community.

There's no need to register, simply turn up. Future dates:

Tuesday 20 August, 5.30pm

Tuesday 24 September, 5.30pm

Tuesday 22 October, 5.30pm

Citizens Advice drop-ins

Citizens Advice is an independent charity that can help you with a range of issues from how to manage debt to how to return faulty goods.

Its advisors offer free one to one sessions every **Thursday, 10am to 1pm**, at the Mascot Hub on Dartmouth Avenue.

No appointment necessary, please drop-in.

Sheerwater Regeneration Housing Support Team

The team has been established to help make the regeneration process as smooth as possible for residents.

You can talk to them about:

- your housing options
- feeling isolated or vulnerable
- fly-tipping
- letters or notices that you have received
- how the project is progressing

Call **01483 743870** or email sheerwater.tenants@woking.gov.uk

Gardening Club

The Gardening Club meets on the last Sunday of every month to look after the community gardens. Whether you're an experienced gardener or just enjoy being outdoors, everyone is welcome to lend a hand. Meet at the community garden (Londis end) at 2.30pm. For more information email sheerwatertogethergroup@woking.gov.uk

